

1EH Low Profile Series Miniature Surface Mount

PRODUCT DESCRIPTIONS

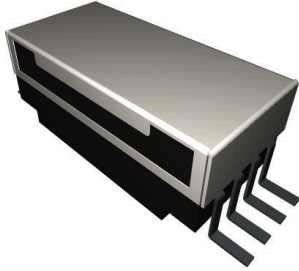

Development philosophy with inherited reliability and assembly capacity of the 1EH Series was put into succession of the 1EH Low Profile Series. Gull-Wing and J-Lead achieved low height of 3.6mm. This series is already in mass production for the ATE, telecommunications, and other instrument markets with great acceptance for low height and reliability.

SPECIFICATIONS



1EH Low Profile		1EH-14G-70	
		1EH-14J-70	
Parameters	Units	1 Form A	Test Conditions
Coil Specifications			
Nominal Coil Voltage	VDC	5.0	
Coil Resistance	Ω	150	$\pm 10\%$ @ 20°C
Operate Voltage	VDC Max	3.75	@ 20°C
Release Voltage	VDC Min	0.7	@ 20°C
Contact Ratings			
Switching Voltage	Volts	100	Max DC/Peak AC resistance
Switching Current	Amps	0.5	Max DC/Peak AC resistance
Carry Current	Amps	1.0	Max DC/Peak AC resistance (@30°C)
Contact Rating	Watts	10	Max DC/Peak AC resistance
Life Expectancy	$\times 10^6$ Cycle	300	@ 1V 10mA
Contact Resistance	m Ω	150	Max initial @ operate voltage
Contact Resistance Stability	m Ω	5.0	Max initial @ operate voltage
Relay Specifications			
Insulation Resistance	Ω Min	10^{11}	Between all isolated pins @ 100V 20°C 65%RH
Dielectric Strength(Static)	VDC Min	200	Between contacts
	VDC Min	250	Contacts to shield
	VDC Min	250	Contacts/Shield to coil
Operate Time (Including Bounce)	msec Max	0.3	@ nominal coil voltage 100 Hz square wave
Release Time	msec Max	0.05	Diode suppression
Measurement Reference Conditions		Environmental Ratings	
Temp: 15°C to 35°C Humidity: 25% to 75%RH Atmospheric Pressure: 860 to 1060hpa		Storage temp: -40°C to +85°C Operate temp: -20°C to +80°C Vibration: 20G's to 2000Hz Shock: 50G's Processing temp: 260°C max for 60sec. dwell time	

Dimensions All Dimensions are inches (mm)

Land Pattern Recommendation

1EH-14G-70

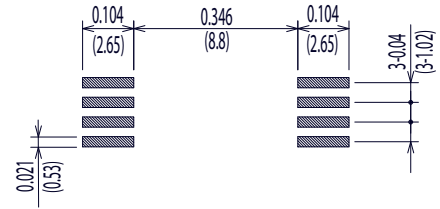
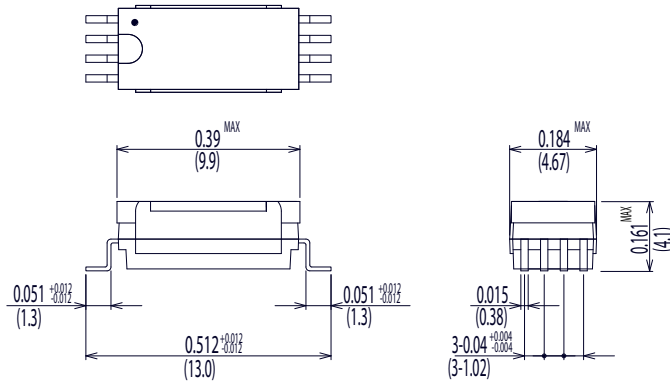

1EH-14J-70

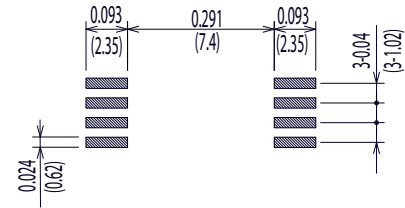
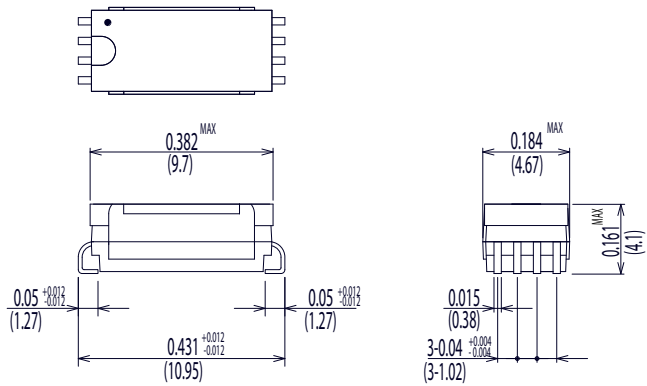

Schematic <Top View>

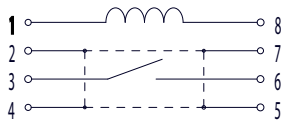

PERFORMANCE DATA

Contact Resistance

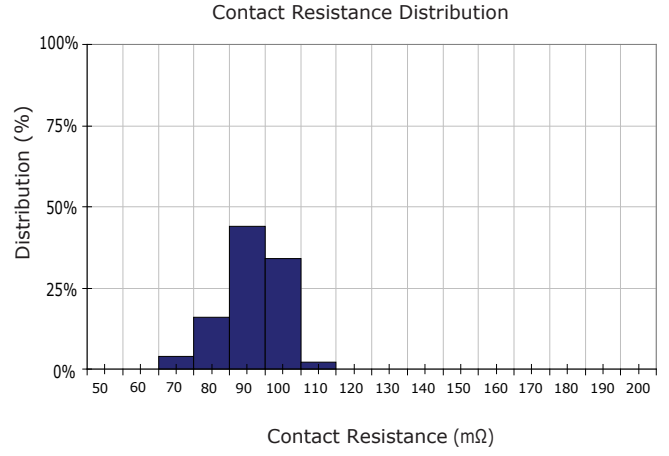
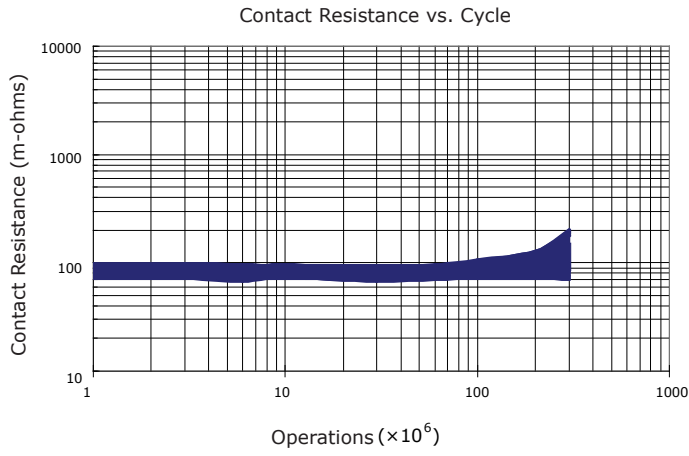

Carry Current

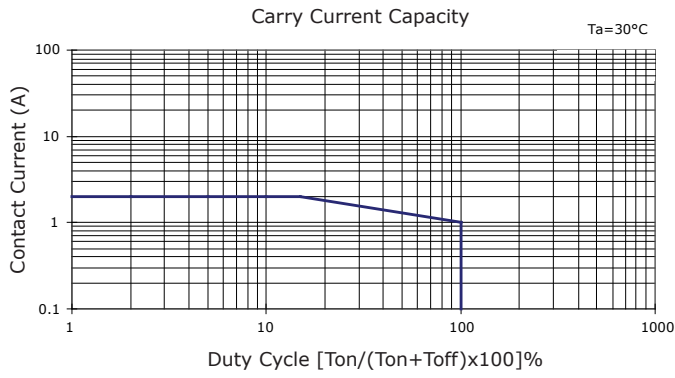

Life

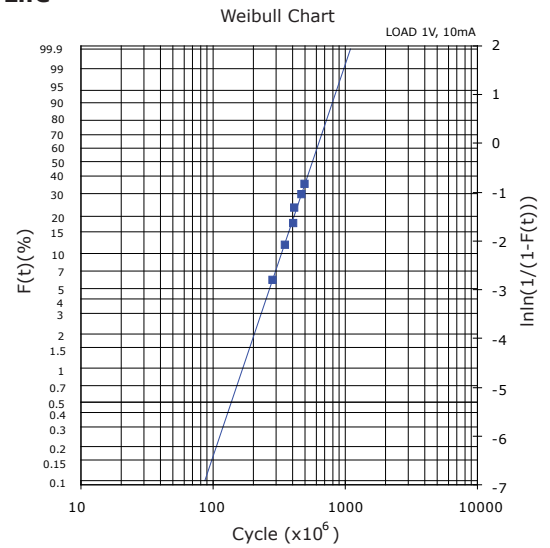

Coil Temperature Rise

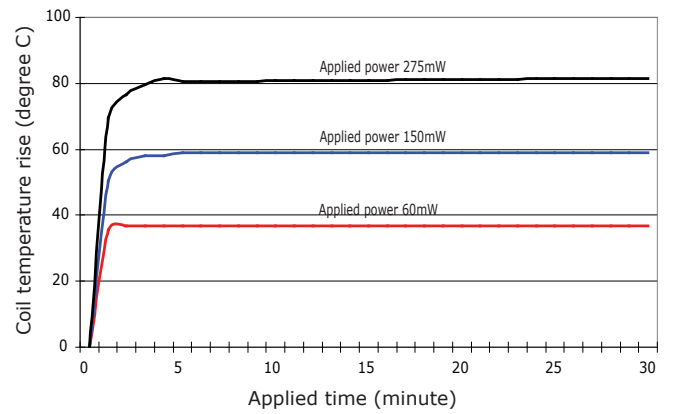
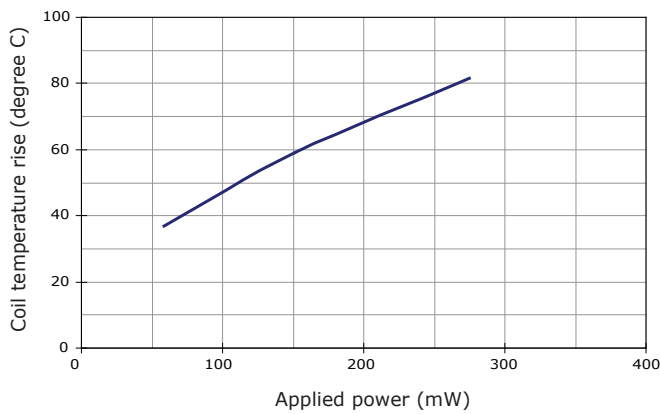

Notes: Reference data of 1EH-14G

Operate and Release Voltage

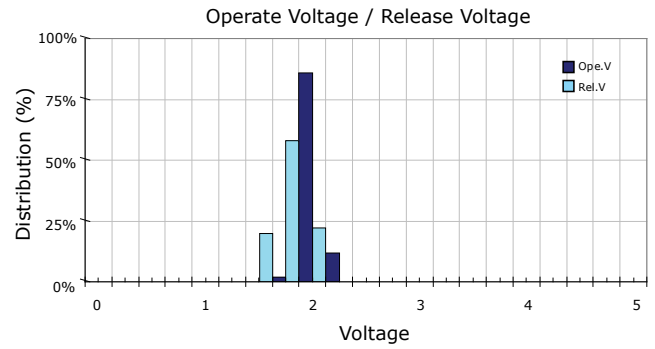
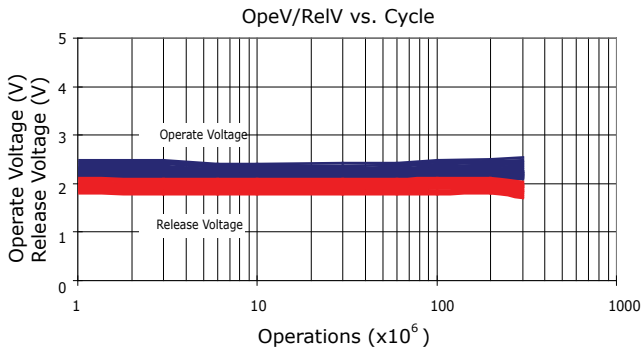
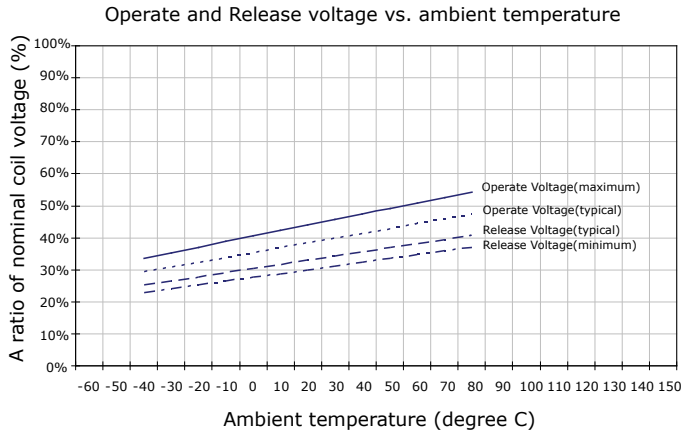

Magnetic Interference

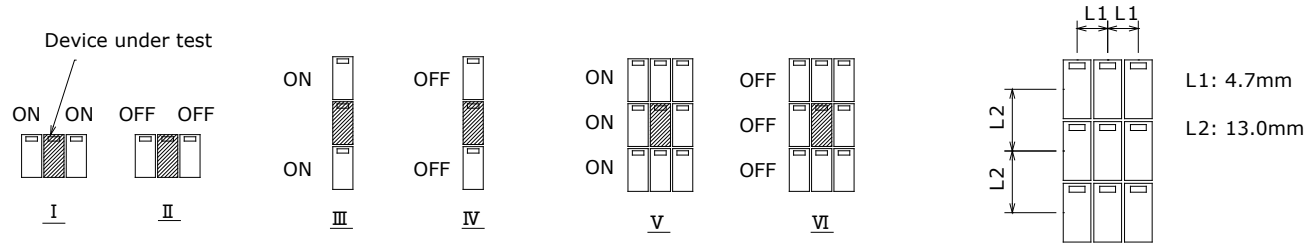
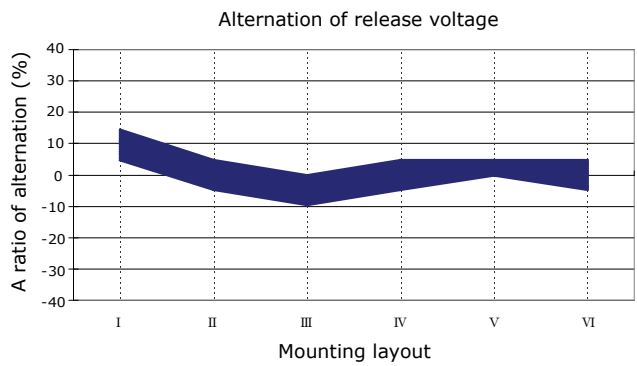
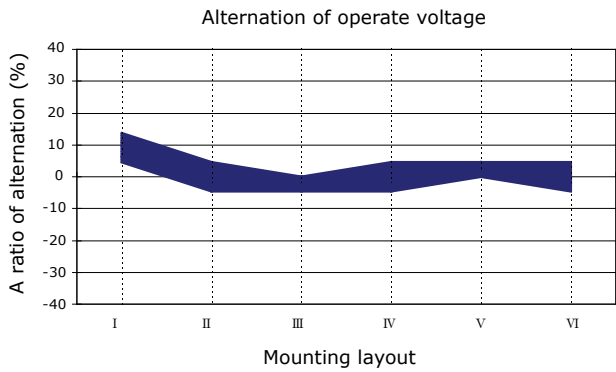

Notes: Reference data of 1EH-14G

S-Parameters

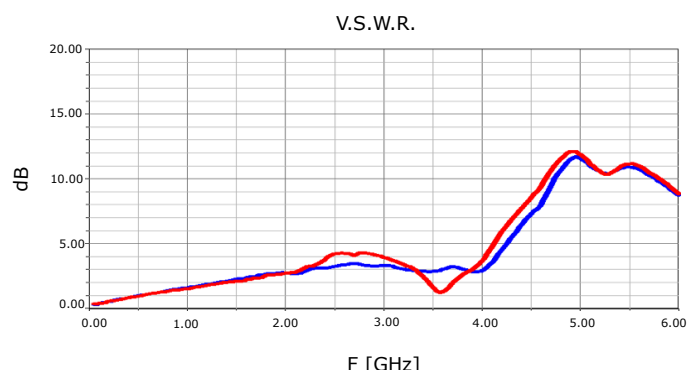
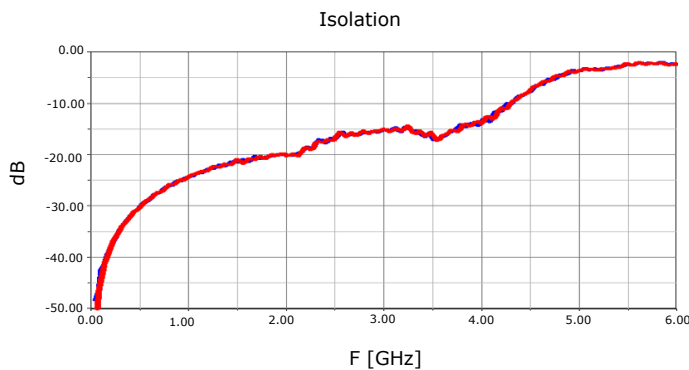
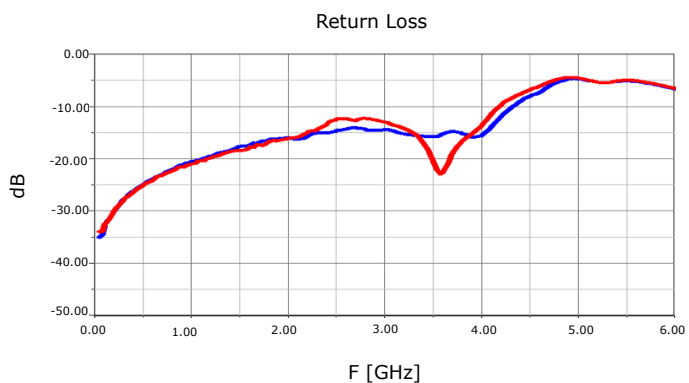
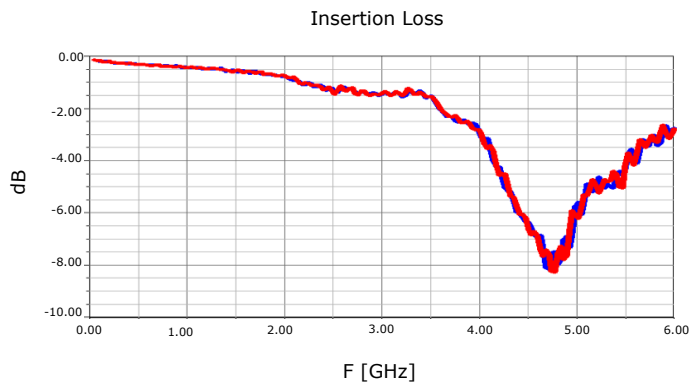

Eye Diagram

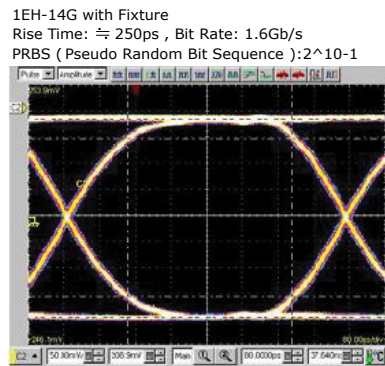
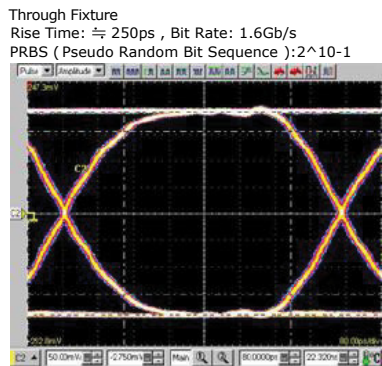
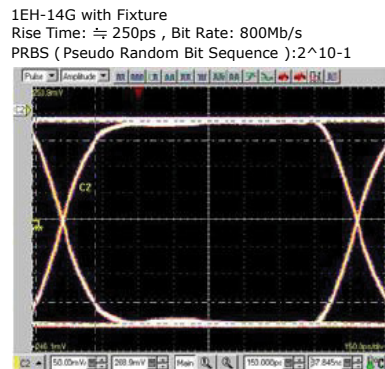
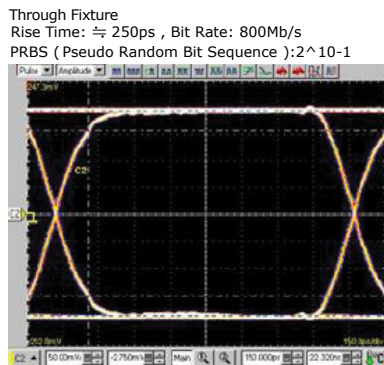

Notes: Reference data of 1EH-14G

Dimensions of Tape and Reel All Dimensions are inches(mm)

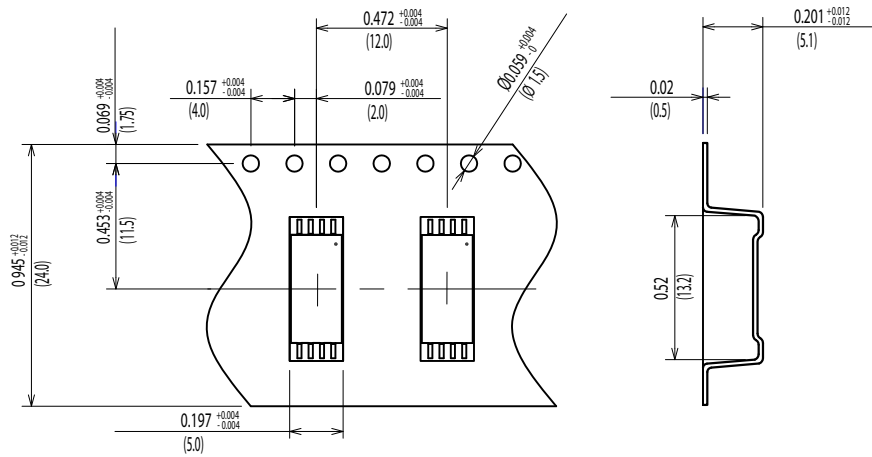

1EH-□4G

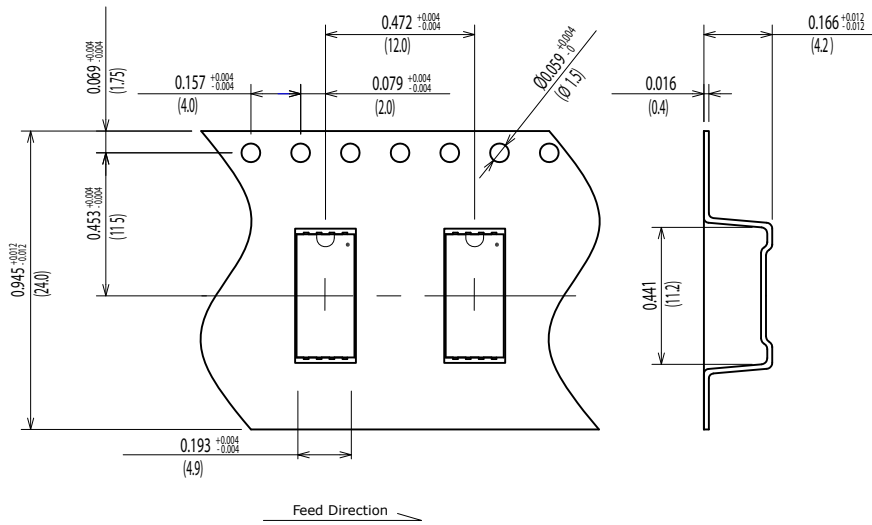

1EH-□4J

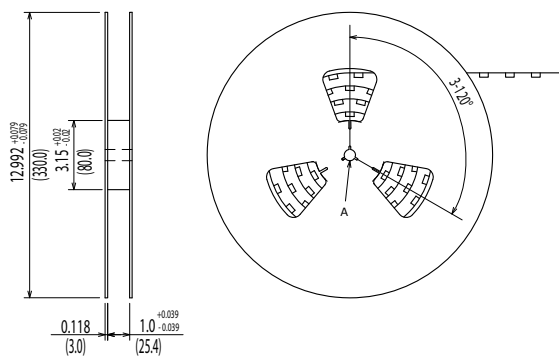

Details of the part A

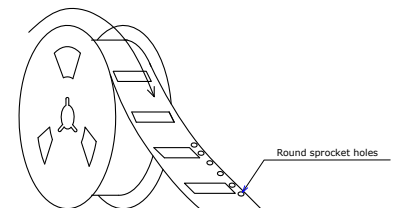
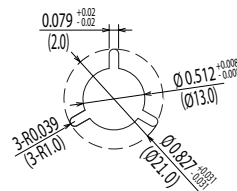

Packing Quantity: 1,000pcs

Packing conforms to EIA standard EIA-481-2 or EIA-481-3