

1EH Series

Miniature Surface Mount

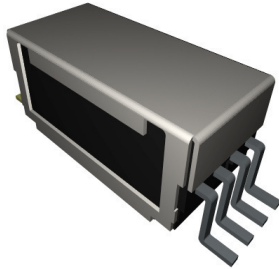

PRODUCT DESCRIPTIONS

As a standard for Sanyu SMT relays, the 1EH Series has been widely accepted by the ATE, telecommunications, and instrument markets. A variety of package styles such as Axial, Gill-Wing and J-Lead are produced to best suit your application needs.

- RF Performance up to 4GHz
- Impedance 50Ω
- UL Certified

SPECIFICATIONS



1EH Series		1EH-54A	1EH-14A	1EH-24A	
		1EH-54G	1EH-14G	1EH-24G	
		1EH-54J	1EH-14J	1EH-24J	
Parameters	Units	1 Form A			Test Conditions
Coil Specifications					
Nominal Coil Voltage	VDC	3.3	5.0	12.0	±10% @ 20°C @ 20°C @ 20°C
Coil Resistance	Ω	80	150	500	
Operate Voltage	VDC Max	2.8	3.75	8.8	
Release Voltage	VDC Min	0.5	0.7	1.2	
Contact Ratings					
Switching Voltage	Volts	100			Max DC/Peak AC resistance Max DC/Peak AC resistance Max DC/Peak AC resistance(@ 30°C) Max DC/Peak AC resistance @ 1V 10mA Max initial @ operate voltage Max initial @ operate voltage
Switching Current	Amps	0.5			
Carry Current	Amps	1.0			
Contact Rating	Watts	10			
Life Expectancy	x10 ⁶ Cycle	300			
Contact Resistance	mΩ	150			
Contact Resistance Stability	mΩ	5.0			
Relay Specifications					
Insulation Resistance	Ω Min	10 ¹¹			Between all isolated pins @ 100V 20°C 65%RH
Dielectric Strength(Static)	VDC Min	200			Between contacts Contacts to shield Contacts/Shield to coil
	VDC Min	250			
	VDC Min	250			
Operate Time (Including Bounce)	msec Max	0.3			@ nominal coil voltage 100 Hz square wave
Release Time	msec Max	0.05			Diode suppression
Measurement Reference Conditions		Environmental Ratings			
Temp: 15°C to 35°C Humidity: 25% to 75%RH Atmospheric Pressure: 860 to 1060hpa		Storage temp: -40°C to +85°C Operate temp: -20°C to +80°C Vibration: 20G's to 2000Hz Shock: 50G's Processing temp: 260°C max for 60sec. dwell time			

Dimensions All Dimensions are inches (mm)

Land Pattern Recommendation

1EH-54A/1EH-14A/1EH-24A

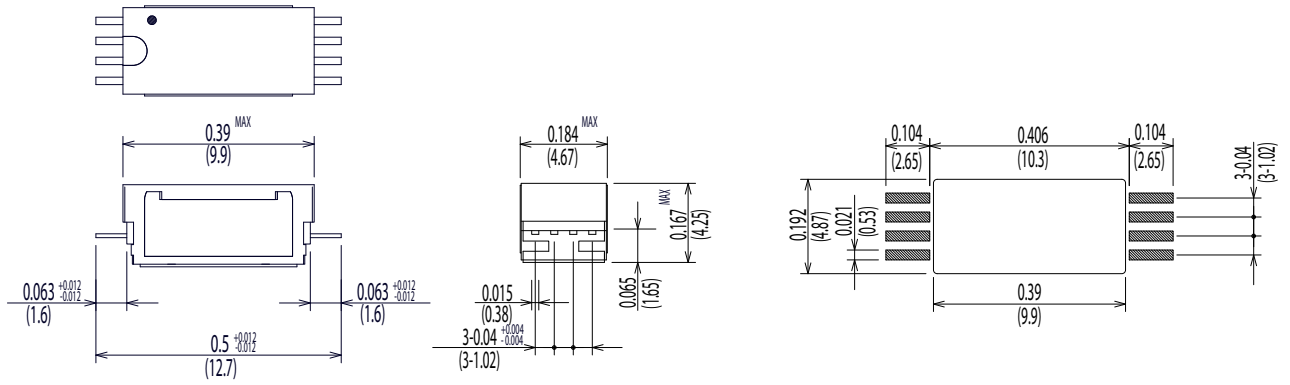

1EH-54G/1EH-14G/1EH-24G

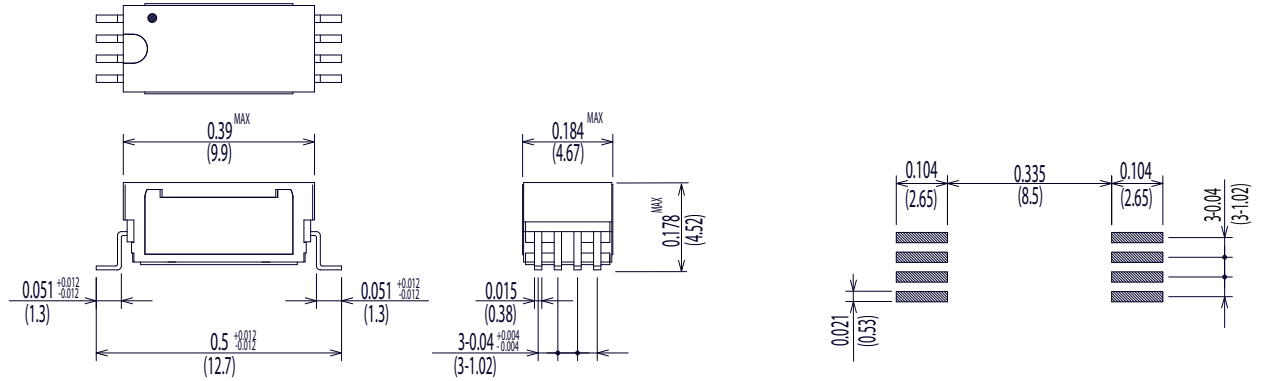

1EH-54J/1EH-14J/1EH-24J

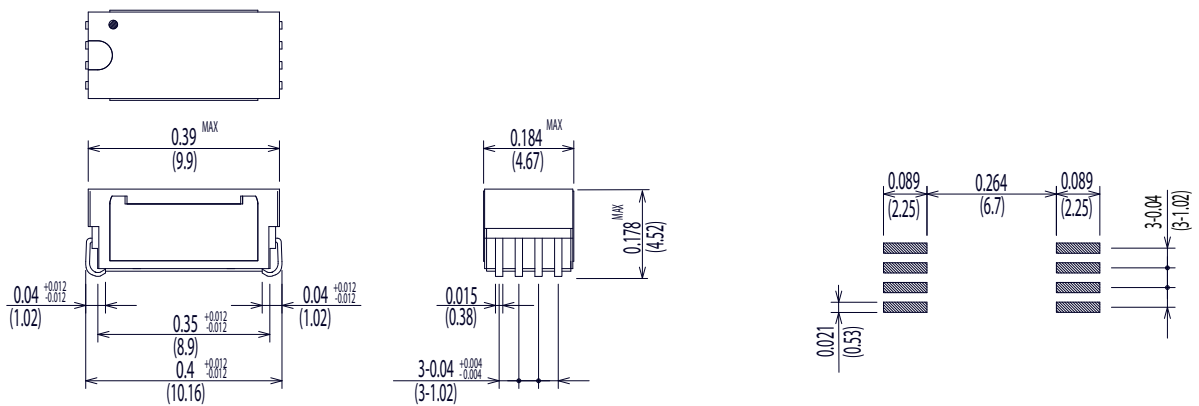

Schematic <Top View>

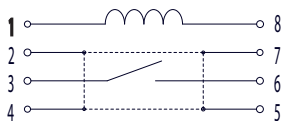

PERFORMANCE DATA

Contact Resistance

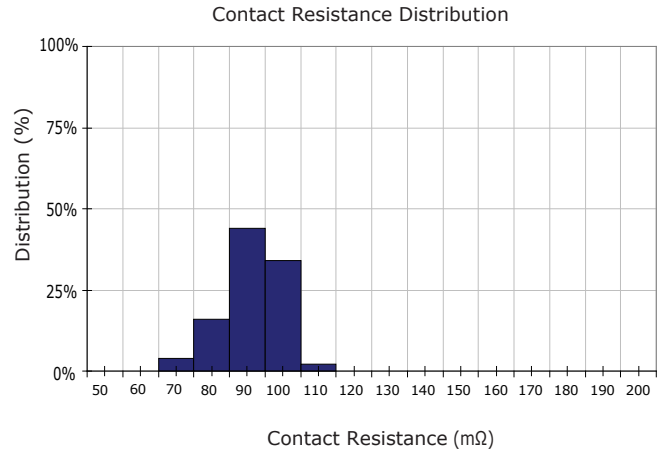
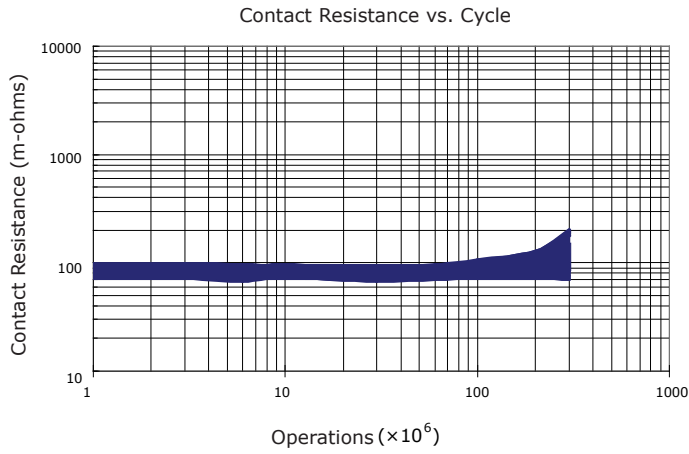

Carry Current

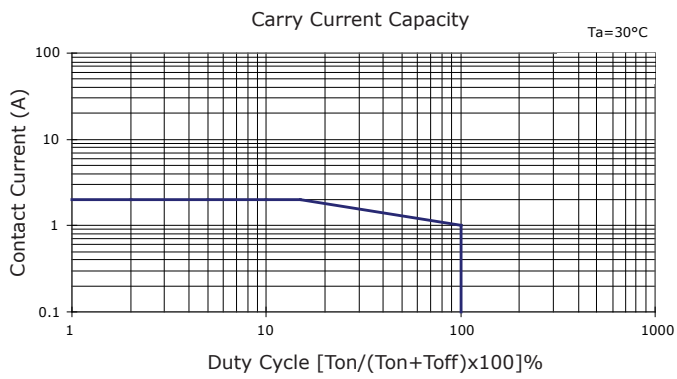

Life

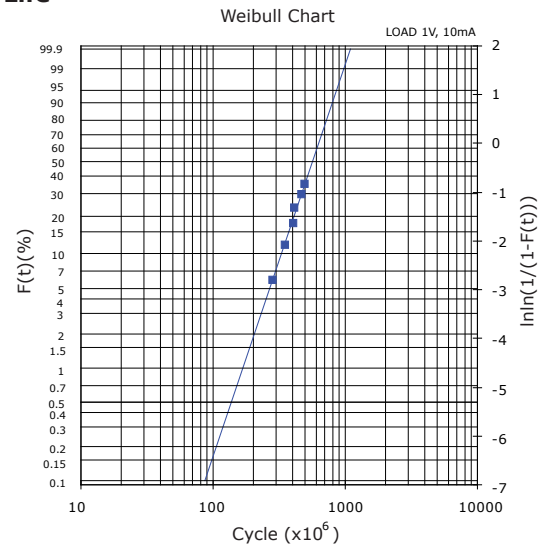

Coil Temperature Rise

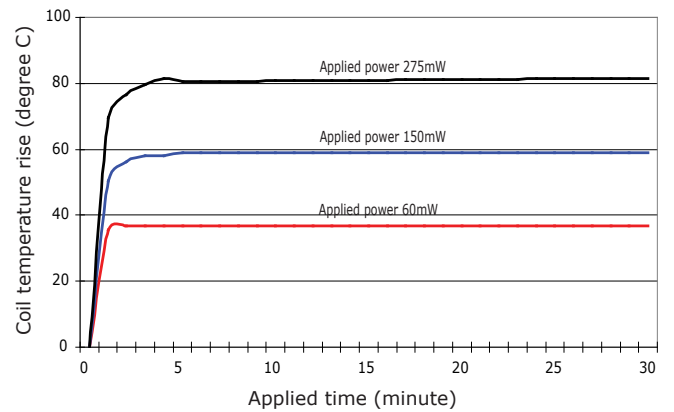
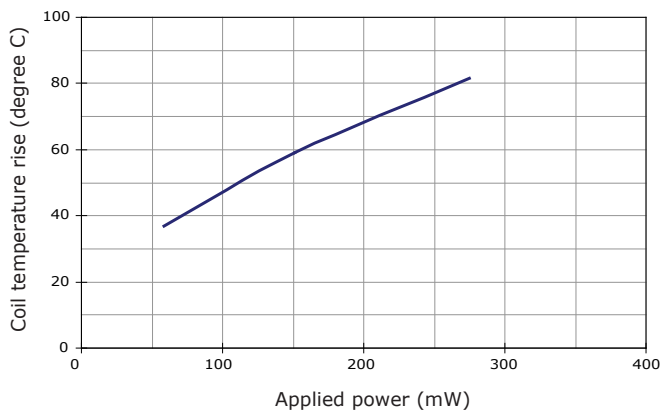

Notes: Reference data of 1EH-14G

Operate and Release Voltage

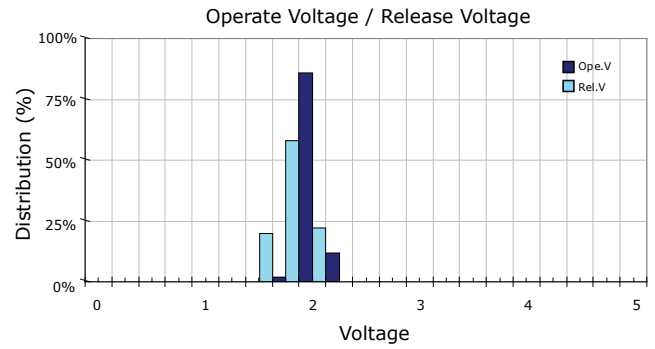
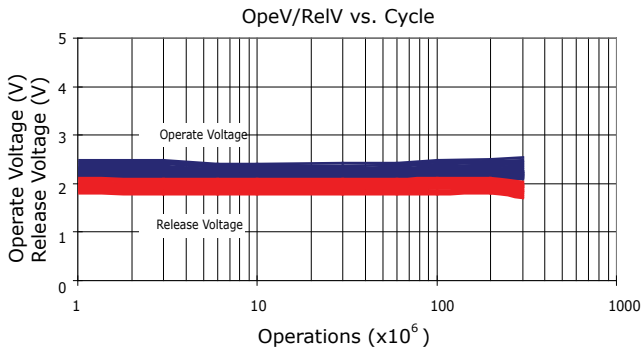
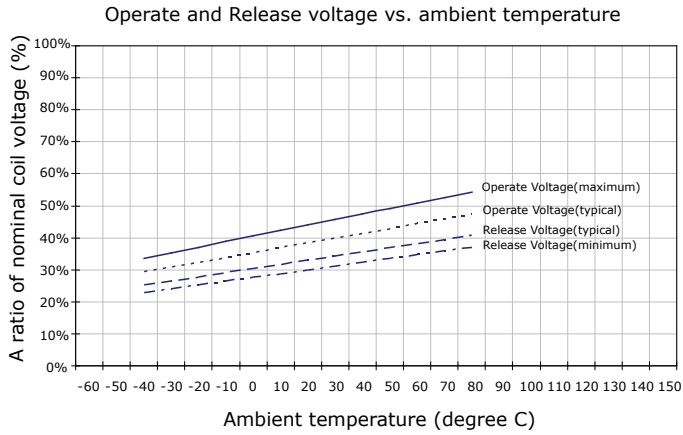

Magnetic Interference

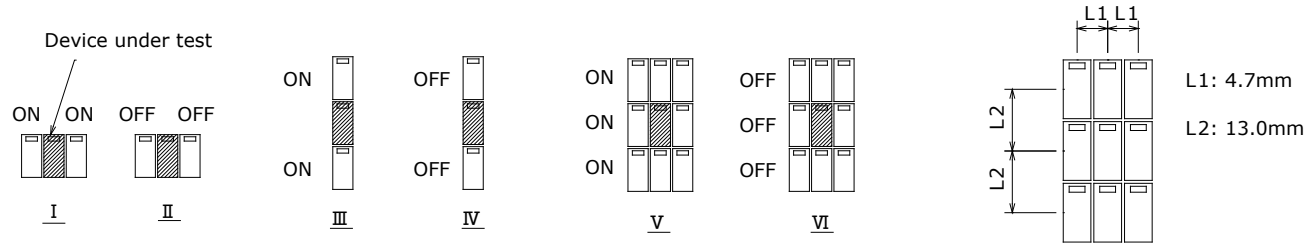
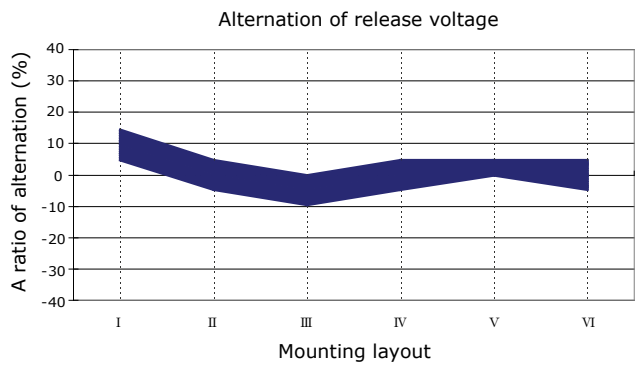
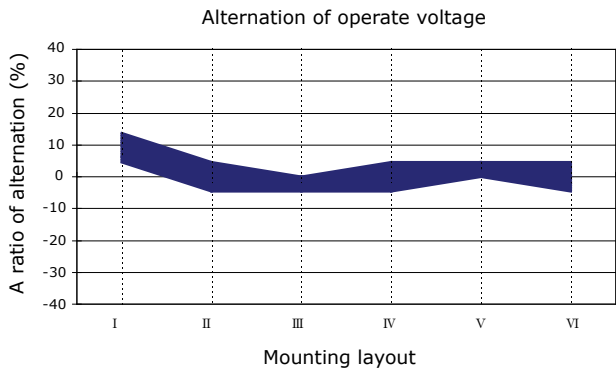

Notes: Reference data of 1EH-14G

S-Parameters

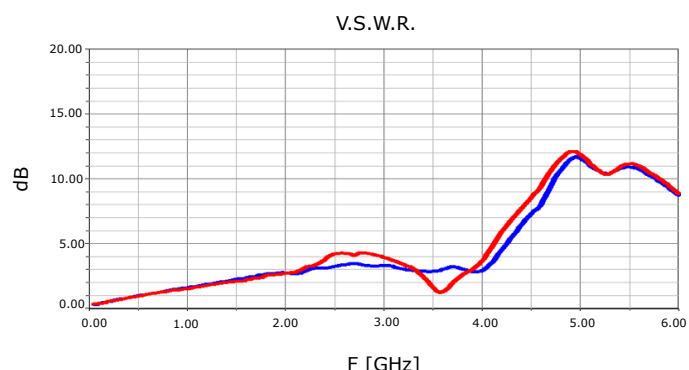
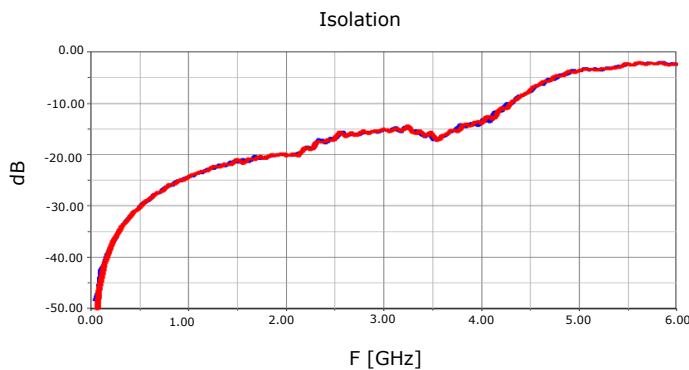
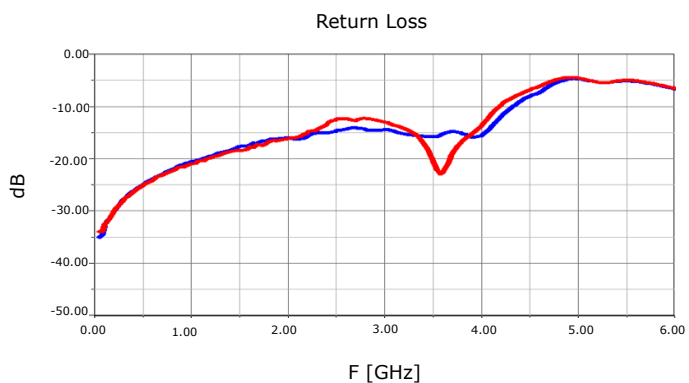
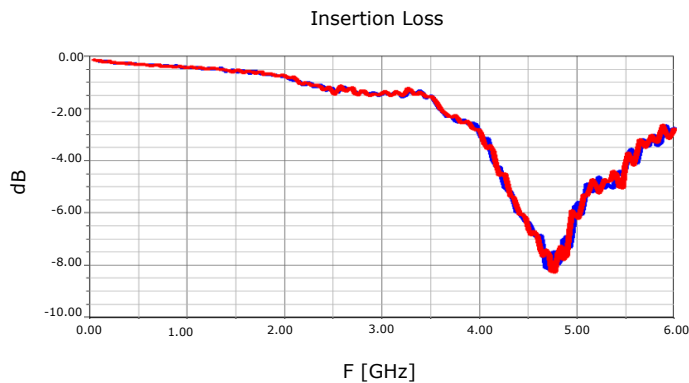

Eye Diagram

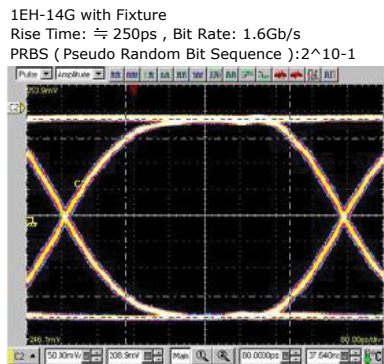
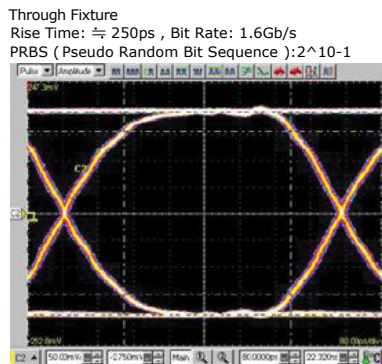
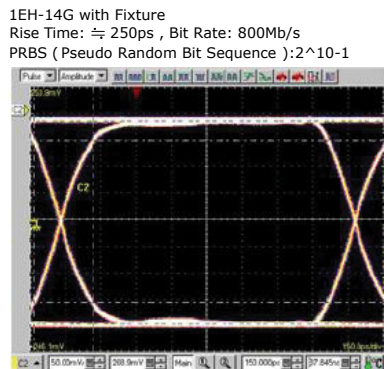
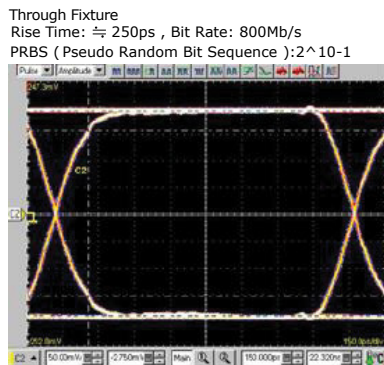

Notes: Reference data of 1EH-14G

Dimensions of Tape and Reel All Dimensions are inches(mm)

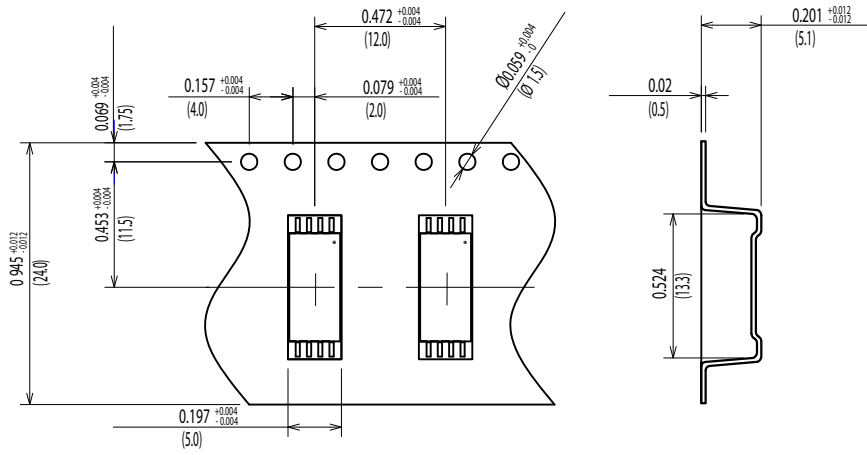

1EH-4A / 1EH-4G

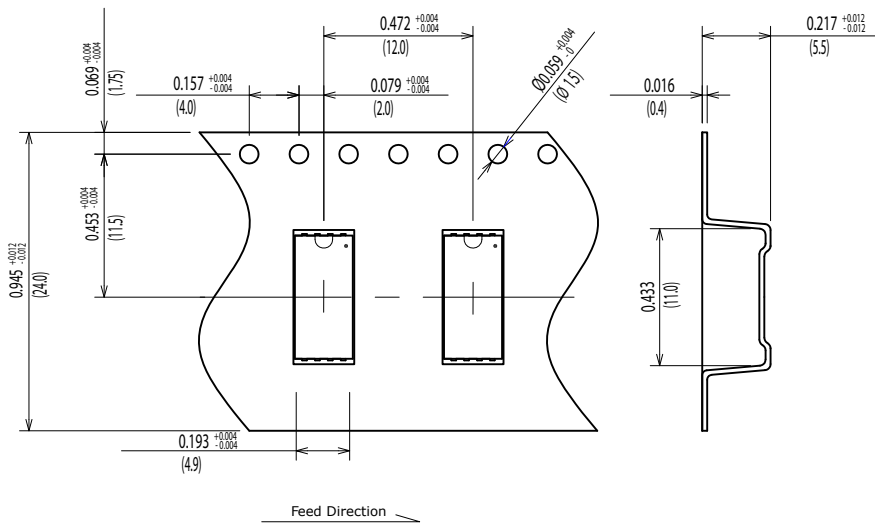

1EH-4J

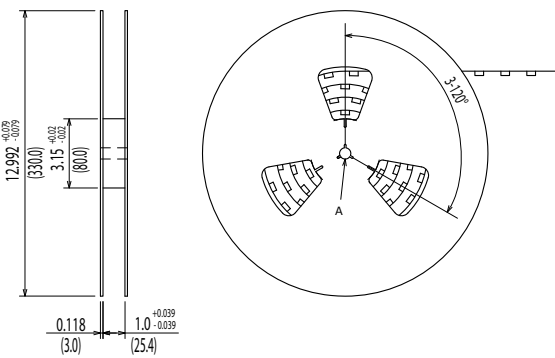

Details of the part A

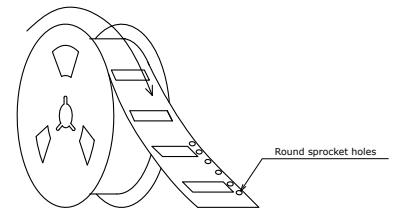
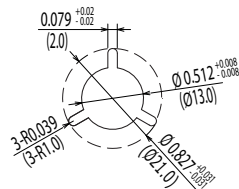

Packing Quantity: 1,000pcs

Packing conforms to EIA standard EIA-481-2 or EIA-481-3